

# Classic TBi 360 Expert

Kühlart / Cooling method	Belastbarkeit [A] / Rating [A]		Einschaltdauer / Duty cycle (10 min.)	Draht-Ø / Wire diam. [mm]		
Gas / gas	Mix (M21)	CO2	300	330	60 %	1.0 - 1.6

Typ / Type	Anschluss / Connector	ausgerüstet mit / fitted for	Biegung / Bend	Art. Nummer / Part no.
▶ TBi 360 Expert	Euro	M6	50°	114P3210_0*
▶ TBi 360 Expert	Euro	M8	50°	114P3B10_0*

### Düsenstock / Tip holder



- ▶ M6 / L=28 mm 342P006014
- M6 / L= 32 mm 342P006114
- ▶ M8 / L= 28 mm 342P008014
- M8 / L= 34 mm 342P008114

### Gasverteiler / Gas diffusors



- ▶ Schwarz / Black 114P002007
- Keramik / Ceramic 114P002005

### Stromdüsen / Contact tips



- ▶ M6x28, Ecu 340P\_\_1069\*
- M6x28, CuCrZr 340P\_\_3069\*
- M6x28 Alu, Ecu 341P\_\_1069\*
- ▶ M8x30, Ecu 340P\_\_1262\*
- M8x30, CuCrZr 340P\_\_3262\*
- M8x30 Alu, Ecu 341P\_\_1262\*

### Gasdüsen / Gas nozzles

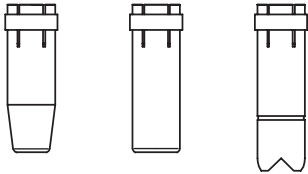

NW 12 345P013010  
 NW 20 345P011010  
 NW 20 345P015010

nur für M6 / only for M6

ESG kpl. / ESG cpl. 701P001048

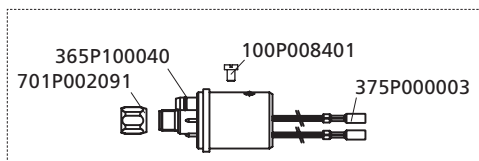

Standard: Ø 1.2 mm

NW 16 345P012010

Knickschutz kpl. / Cable support cpl. 700P001087

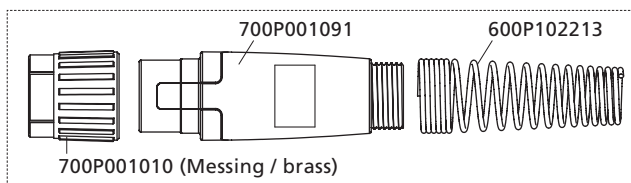

Griffschale ,Expert' kpl. / Handle kit ,Expert' cpl. 380P230001

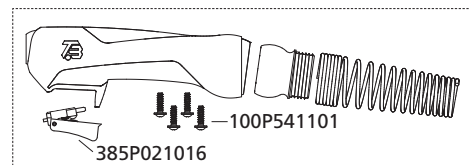

▶ Standard / Standard 385P021018

\*Bitte an Leerstelle entsprechende Angaben für Brennerlänge oder Drahtdurchmesser einsetzen, z.B. 08 für 0.8 mm oder 3 für 3 m. At the blank, please insert suitable information for torch length or wire diameter, e.g. 08 for 0.8 mm or 3 for 3 m.

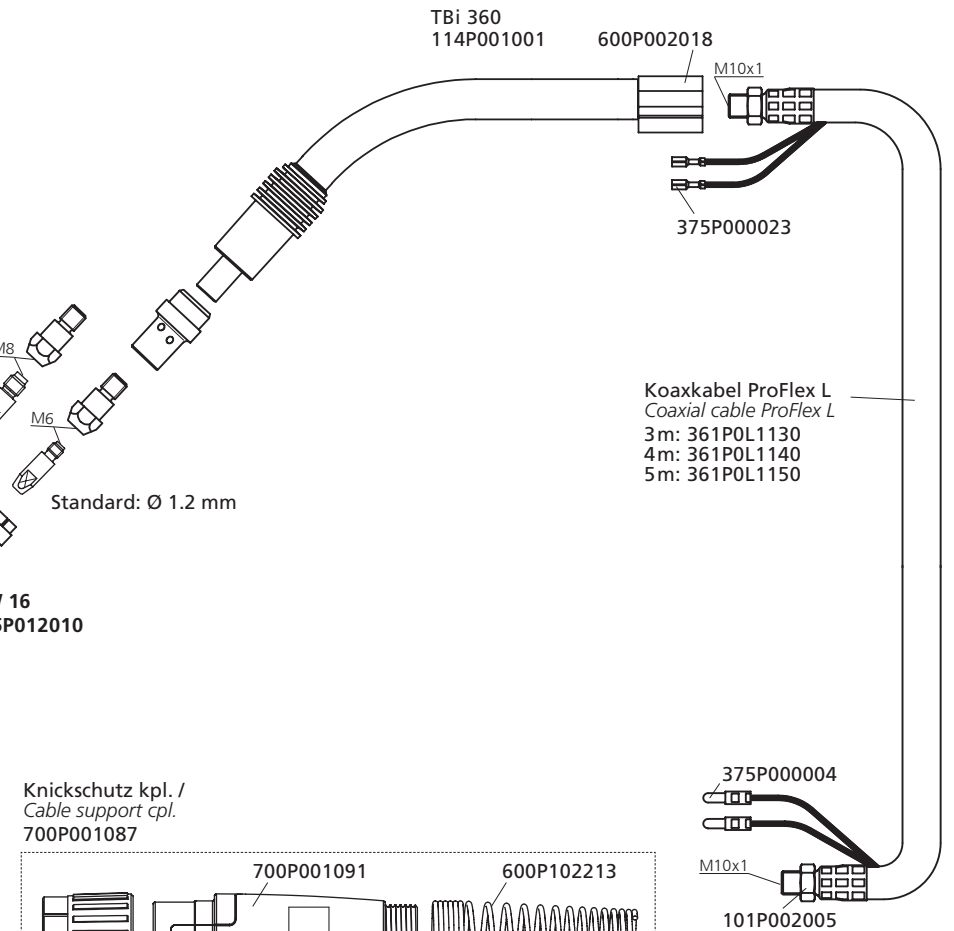

Drahtführungen / Wire guides	Ø [mm]	Farbe / Color	3 m	4 m	5 m
Drahtführungsspirale für Stahldraht / Liner for steel wire	1.0 - 1.2	rot / red	▶324P204534	▶324P204544	▶324P204554
	1.2 - 1.6	gelb / yellow	324P254534	324P254544	324P254554
PTFE-Seele mit Bronzespirale für Alu- und Edelstahldraht / PTFE liner with bronze liner for alu- and stainless steel wire	1.0 - 1.2	rot / red	326P20403A	326P20404A	326P20405A
	1.2 - 1.6	gelb / yellow	326P27473A	326P27474A	326P27475A
PA-Seele mit Bronzespirale für Aludraht / PA liners with bronze liner for aluminium wire	0.8 - 1.0	anthrazit / anthracite	328P20403A	328P20404A	328P20405A
	1.2 - 1.6	anthrazit / anthracite	328P23473A	328P23474A	328P23475A