

Classic TBi 250 Expert

Kühlart / Cooling method	Belastbarkeit [A] / Rating [A] Mix (M21) CO ₂		Einschaltdauer / Duty cycle (10 min.)	Draht-Ø / Wire diam. [mm]
Gas / gas	200	230	60 %	0.8 - 1.2

Typ / Type	Anschluss / Connector	Biegung / Bend	Art. Nummer / Part no.
TBi 250 Expert	Euro	50°	104P3210_0*





Düsenstock / Tip holder

- ▶ M6 / L=35 mm 342P006003
- M8 / L=35 mm 342P008003

Stromdüsen / Contact tips

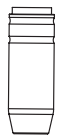
- ▶ M6x28, ECU 340P__1069*
- M6x28, CuCrZr 340P__3069*
- M6x28 Alu, ECU 341P__1069*
- M8x30, ECU 340P__1262*
- M8x30, CuCrZr 340P__3262*
- M8x30 Alu, ECU 341P__1262*

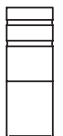
Gasdüsen / Gas nozzles

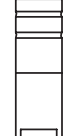
- | | | | | | |
|--|---|---|---|---|---|
|  |  |  |  |  |  |
| NW 15
345P012303
lange Isolation/
long insulation | NW 11
345P013003
nur für M6 /
only for M6 | NW 20
345P011303
lange Isolation/
long insulation | NW 14
345P014003 | NW 11
345P014303
nur für M6 /
only for M6 | NW 19
345P015503
lange Isolation/
long insulation |

ESG kpl. / ESG cpl.

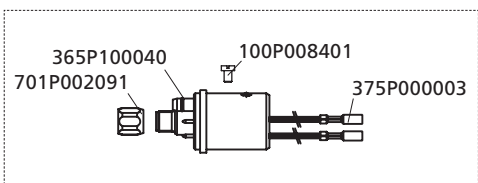

Knickschutz kpl. / Cable support cpl.

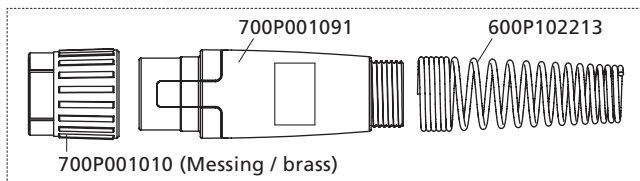

Griffschale ,Expert' kpl. / Handle kit ,Expert' cpl.

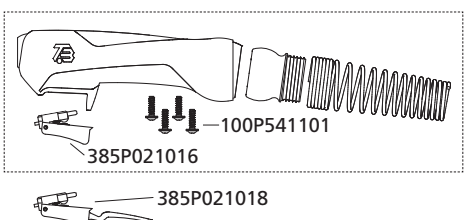

▶ Standard / Standard

*Bitte an Leerstelle entsprechende Angaben für Brennerlänge oder Drahtdurchmesser einsetzen, z.B. 08 für 0.8 mm oder 3 für 3 m.
At the blank, please insert suitable information for torch length or wire diameter, e.g. 08 for 0.8 mm or 3 for 3 m.

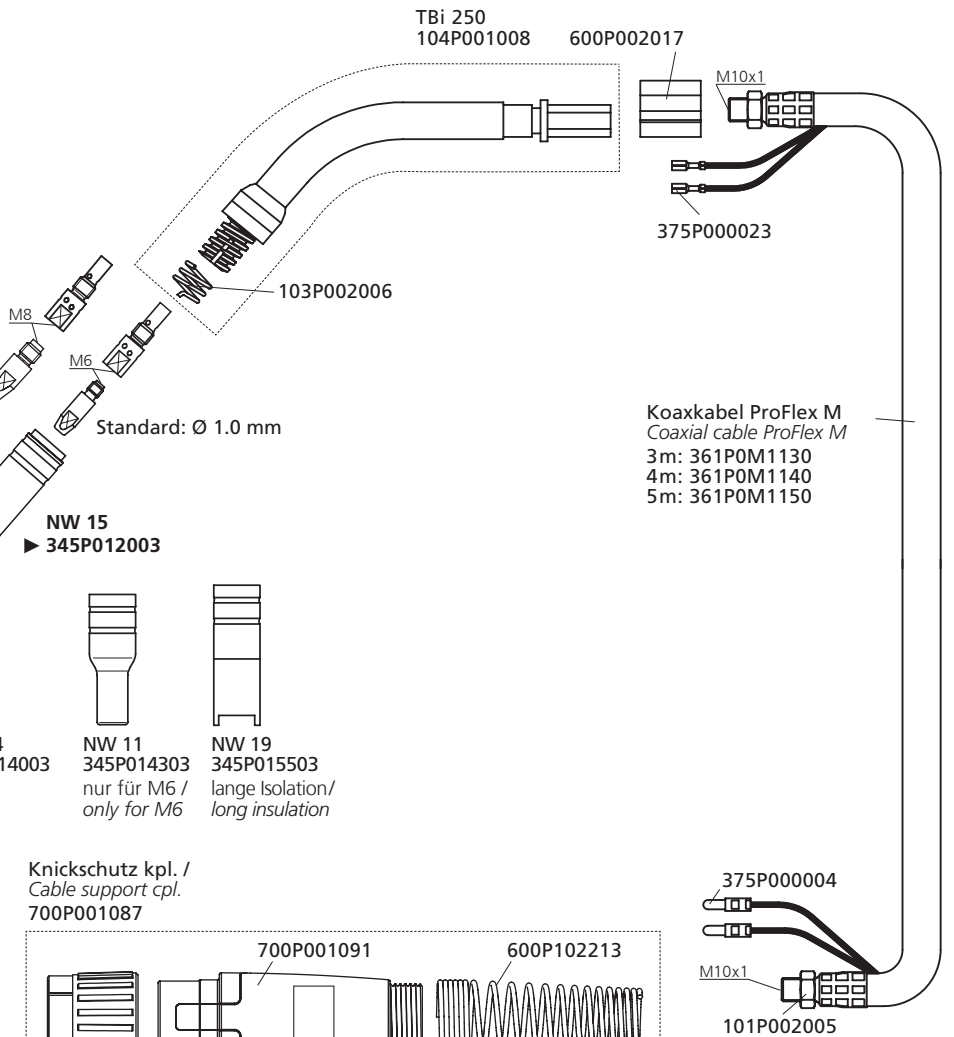

Koaxkabel ProFlex M
Coaxial cable ProFlex M
3m: 361P0M1130
4m: 361P0M1140
5m: 361P0M1150

Drahtführungen / Wire guides

Drahtführungsspirale für Stahldraht / Liner for steel wire	Ø [mm]	Farbe / Color	3 m	4 m	5 m
	0.8 - 1.0	blau / blue	324P154534	324P154544	324P154554
	1.0 - 1.2	rot / red	▶324P204534	▶324P204544	▶324P204554
PTFE-Seele mit Bronzespirale für Alu- und Edelstahldraht / PTFE liner with bronze liner for alu- and stainless steel wire	0.8 - 1.0	blau / blue	326P15403A	326P15404A	326P15405A
	1.0 - 1.2	rot / red	326P20403A	326P20404A	326P20405A
PA-Seele mit Bronzespirale für Aludraht / PA liners with bronze liner for aluminium wire	0.8 - 1.0	anthrazit / anthracite	328P20403A	328P20404A	328P20405A